

Quick Start Assembly/Install Instructions
CLEARSTREAM™ Micron-R™

Connect the antenna to the TV or receiver and run a full **channel scan**.
 If reception is not as desired, move the antenna and **rescan** TV/receiver.

Tools Required: Cross Point screwdriver.

Before beginning assembly, make sure all pieces needed are present.

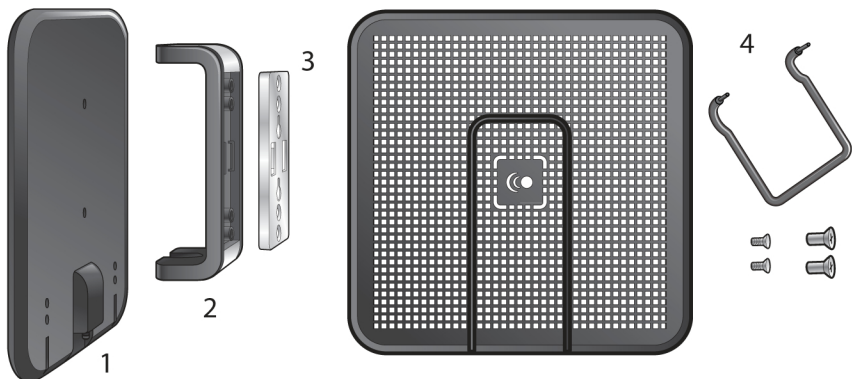

The CLEARSTREAM Micron-R Indoor Antenna comes with:

- 1 - Antenna
- 2 - Stand mounting base
- 3 - Flush mounting insert
- 4 - Reflector with U-bracket and base hardware

- 1 Remove insert from base at center holes. Fig 1 - 1a.
- 2 Lay U-bracket into mounting base with hooks pointing downward. Place base insert on top as shown in Fig. 2.

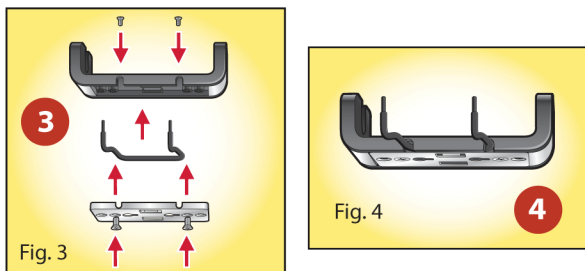
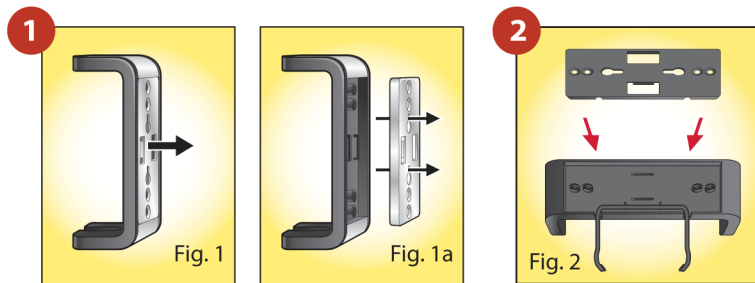

- 3 Attach components together with Reflector base screws (use the inside holes) provided as shown in Fig. 3. Small screws fit into the larger screws.
- 4 Place completed base on flat surface. Fig. 4.

Slide the Micron-R onto it's base:

- 1 Place antenna into base as shown in Fig.5.
- 2 Tabs in base will fit into grooves on back plate of antenna. Fig.5a.



Attach Reflector:

- 3 Slide Reflector down onto U-bracket as shown in Fig. 6. Reflector is properly attached.
- 4 Connect cable to TV or receiver.
- 5 Change TV input to "Antenna" or "Air" and then perform **channel scan**. Refer to your TV/receiver owners manual for instructions.

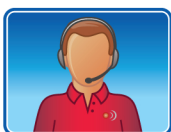

Call to Learn. Technical Assistance is available Monday - Friday, 9am - 9pm Central Time
 1-877-825-5572 and Saturday - Sunday, 10am - 6pm.